

# ITEM NO. :T5345DU-C

## ASSEMBLY INSTRUCTIONS

- 1.Put lampshade (A) inside lampshade (B) and put lampshade (C) inside lampshade (B) upside down.
  - 2.Drill holes on the wall according to the size of plastic drywall anchor and gently tap the plastic drywall anchor (D) into the hole.
  - 3.Screw the hook (E) into the plastic drywall anchor.
  - 4.Wrap the wires around the hook on the 8-shaped fastener (F) and hang the 8-shaped fastener (F) to the hook (E). You can also hang the wires directly on the hook (E) and manage the wires with the wire wrap strap (G) included.
  - 5.Attach the assembled lampshade (H) to the socket using the socket ring (J) to secure.
- Please consult a qualified Electrician if you are not familiar with electrical wiring.*

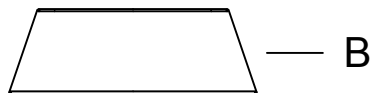
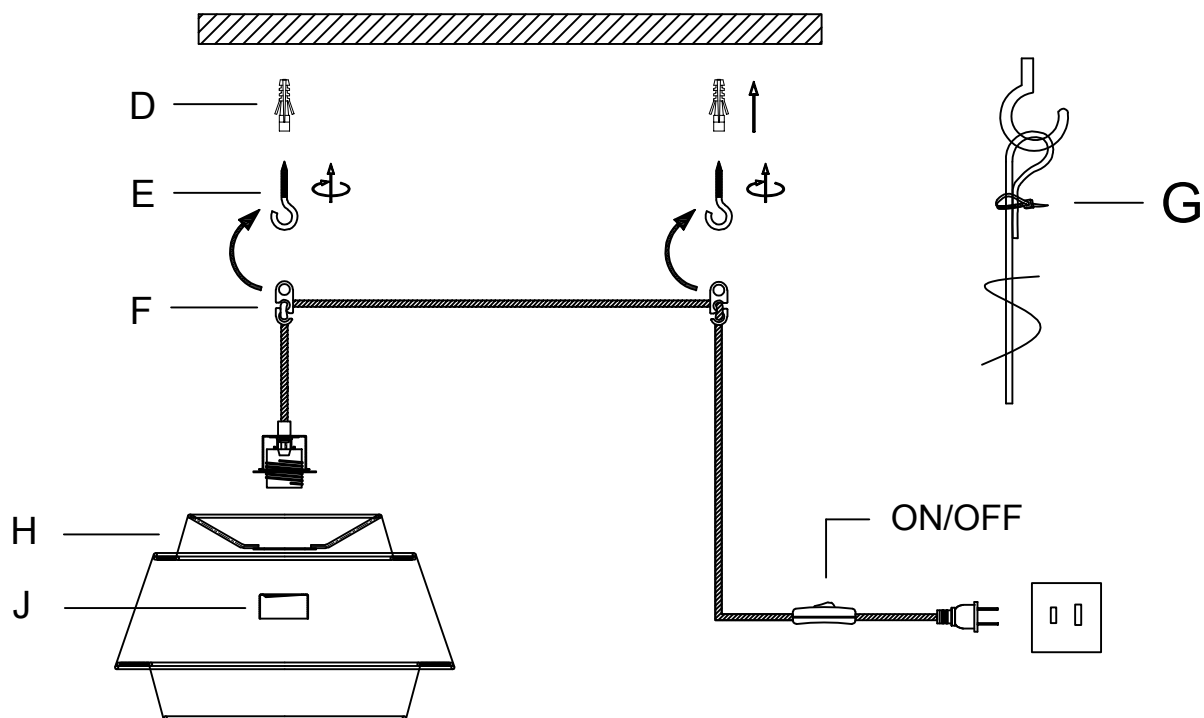

B



A

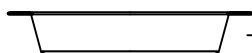

C

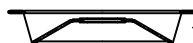

A

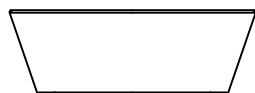

B



C

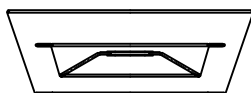

B

